

## Regular-Duty

Up to 150 lbs./pair\*

Adjustable Shelf Brackets



## 1186 Series Regular-Duty Adjustable Bracket

- Applications** For closet or other storage applications.
- Load Rating** Up to 150 lbs. per pair\*
- Mounting** Wall
- Material** 13- and 16-gauge steel
- Finishes** Warm White (WT)
- Features**
- For 11" to 14" deep shelves
  - Brackets can be mounted to any type of wall
  - Shelf platform adjusts from 10-1/4" to 10-3/4"
  - Install with or without wall cleat

\*Contact KV Customer Service for more information.

### Builder Pack (BP)

| Size | Warm White (WT) |
|------|-----------------|
| 12"  | 1186BP WT 12    |

# 1186 Series Regular-Duty Adjustable Shelf Bracket

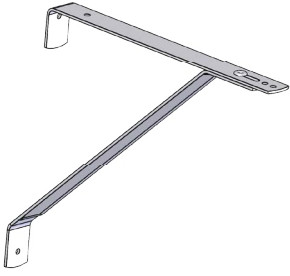

## 1. Product Name

**1186 Series Regular-Duty Adjustable Shelf Bracket.** For regular-duty shelving in industrial, commercial, retail and residential applications.

## 2. Manufacturer

Knapé & Vogt® Manufacturing Company  
2700 Oak Industrial Dr. NE, Grand Rapids, MI USA 49505-6026  
616.459.3311 | [www.kv.com](http://www.kv.com)

## 3. Product Description

**Basic Use:** 1186 Regular-Duty Adjustable Shelf Brackets are manufactured for closet of other storage applications. Mounts to any wall type.

### Composition and Materials:

1186: 13-gauge steel

### Sizes:

1186: 9-3/4" high x 10-1/4" deep x 1" wide

**Finishes:** Warm White (WT)

## 4. Technical Data

**Applicable Standards:** Brackets are tested to meet or exceed the ANSI performance standards as established by BHMA.

These load limits are intended to be used as general guidelines only, and no warranty — expressed or implied—is made by Knapé & Vogt.

Results were obtained by laboratory testing in accordance with ANSI/ BHMA A156.9-2003 performance standard. (Load ratings based on brackets being mounted on 16" centers. Wider spacing will result in reduced load capacity.) Actual use conditions will typically result in lower load capacity than laboratory conditions.

Representative testing in a fully configured application is the only way to assure proper performance, durability, and safety.

### Environmental Considerations:

**Environment:** Excessive humidity, salts, or other chemical agents can corrode the finish and attack metal or plastic components.

**Fastening:** Inadequate or incorrect fasteners can result in the brackets pulling loose and causing damage.

**Alignment:** Improper bracket alignment can result in a system that is ineffective and unsafe.

## 5. Installation

For maximum loading capacity, brackets should be mounted directly to wall studs, which are generally found on 16" centers. Prior to drilling all holes, check to be sure that the bracket is vertically level.

Attach one bracket to wall stud by fastening one #10 x 2" screw through the top mounting hole in bracket. Use a level to position the second bracket at the same height as the first bracket and fasten it to a wall stud using one 2" screw through the top mounting hole.

Center the shelf on the brackets. Fasten a #8 screw through rear most mounting hole on each bracket. Confirm that the shelf fits properly and adjust position of brackets if necessary.

Finish securing the brackets to the wall by fastening #10 x 2" screws through the second wall mounting hole.

Finish securing the brackets to the shelf by fastening a #8 screw through the front mounting hole.

## 6. Availability and Cost

**Availability:** Knapé & Vogt (KV) products are available from stocking distributors and through KV Representatives worldwide.

**Cost:** Current pricing is available from area KV Representatives. Please call for the nearest representative at: 800.253.1561.

## 7. Warranty

**Limited Lifetime Warranty:** Knapé & Vogt offers its standard Limited Lifetime Warranty to the initial purchaser of commercial products. This warranty covers defects in materials and workmanship which occur during normal use, and the remedy is limited to repair or replacement of defective products, at KV's option. Certain types of defects and damage are excluded from warranty coverage, costs and expenses are not covered, and additional restrictions apply. A copy of the Limited Lifetime Warranty, with all warranty details, limitations and disclaimers, is available on the Customer Care Connection location at [www.kv.com](http://www.kv.com) or from KV Customer Service, 2700 Oak Industrial Drive, Grand Rapids, MI 49505, 800.253.1561.

## 8. Maintenance

1186 Regular-Duty Adjustable Shelf Brackets require no maintenance. Inspect for proper fit periodically and adjust when necessary. Replace as required or recommended by application.

## 9. Technical Services

Knapé & Vogt and area representatives can assist with any application. For further information, or for the name of the representative nearest you, please call Knapé & Vogt Customer Service: 800.253.1561 or visit our website at: [www.kv.com](http://www.kv.com).

## 10. Filing Systems

Additional product information, data sheets, application sheets, and a full catalog are available upon request from Knapé & Vogt.



**KNAPE & VOGT**

2700 Oak Industrial Dr. NE  
Grand Rapids, MI 49505-6026 USA  
1.800.253.1561 | 616.459.3311  
Fax: 877.636.3290  
[www.kv.com](http://www.kv.com)

**BHMA** Knapé & Vogt shelving products follow the ANSI testing standards established by BHMA.

*This and other KV literature is available for download at [www.kv.com](http://www.kv.com) > Resource Library*  
*Knapé & Vogt reserves the right to change product specifications at any time without notice and without incurring responsibility for existing units. This information conforms to editorial style prescribed by The Construction Specifications Institute.*  
©2016 Knapé & Vogt. KV and the KV logo are trademarks of Knapé & Vogt.

OL2903/1116