

Individual Hardware Replacement Parts

1 LS-UNIMNT-DWL

Doweled Plastic Unimount Plate
 (For Polymer/Wood Full-Round and Kidney Lazy Susans)

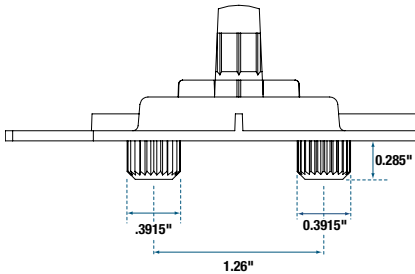
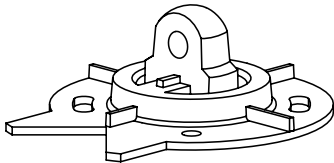

4 PLC-BR-C-10

Beauty Cap
 (For Polymer 18" & 20" Full-Round and 18" Kidney Lazy Susans)

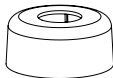

5 PLC-BROS-C-10

Beauty Cap (Oversized)
 (For Polymer 28" & 32" Full-Round, 24" & 32" Kidney and 22" D-Shaped Lazy Susans)

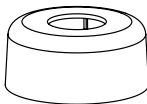

6 RH7G-W

Slide & Shelf Frame Assembly
 (For Wire Half-Moon Glide-Out Lazy Susans.)

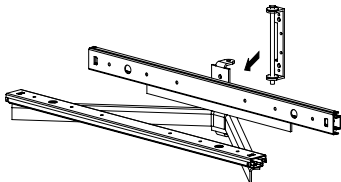

2 LS-UNIMNT-AA

Plastic Unimount Plate
 (For Polymer/Wood Full-Round and Kidney Lazy Susans)

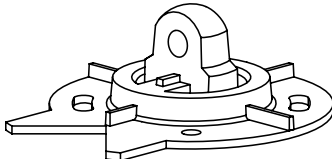

3 HUB-PIN

Bearing Pin for Lazy Susans
 (For Polymer/Wood Full-Round, Kidney Door-Mount, and Single Shelf Lazy Susans)

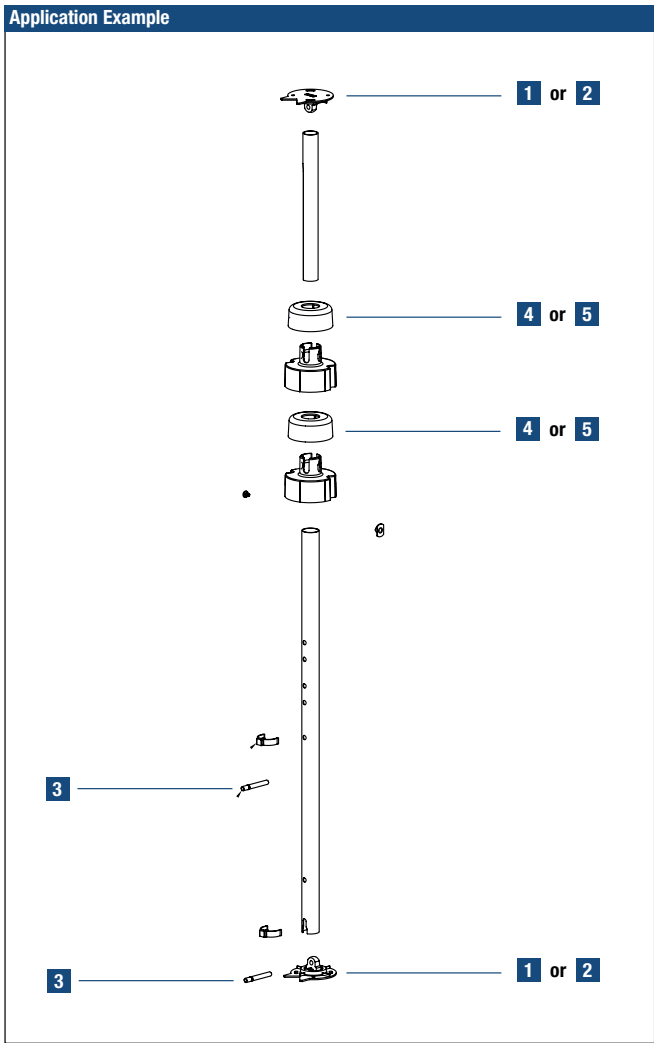
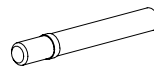

Stock #	Description	Units	Weight per Unit
INDIVIDUAL HARDWARE PARTS (SOLD PER UNIT)			
1 LS-UNIMNT-DWL	Doweled Plastic Unimount Plate	1	0.04 lbs. [0.02 kg.]
2 LS-UNIMNT-AA	Plastic Unimount Plate	1	0.07 lbs. [0.03 kg.]
3 HUB-PIN	Bearing Pin for Lazy Susans	1	0.5 lbs. [0.2 kg.]

Stock #	Description	Units per Carton	Weight per Carton
INDIVIDUAL HARDWARE PARTS (SOLD PER CARTON)			
4 PLC-BR-C-10	Beauty Cap	10	1.5 lbs. [0.68 kg.]
5 PLC-BROS-C-10	Beauty Cap (Oversized)	10	0.4 lbs. [0.18 kg.]
6 RH7G-W	Slide & Shelf Frame Assembly	2	12.8 lbs. [5.8 kg.]

Lazy Susan Post Replacement Parts

1 For POLYMER Full-Round / Kidney Shelves

2 For WOOD Full-Round / Kidney Shelves

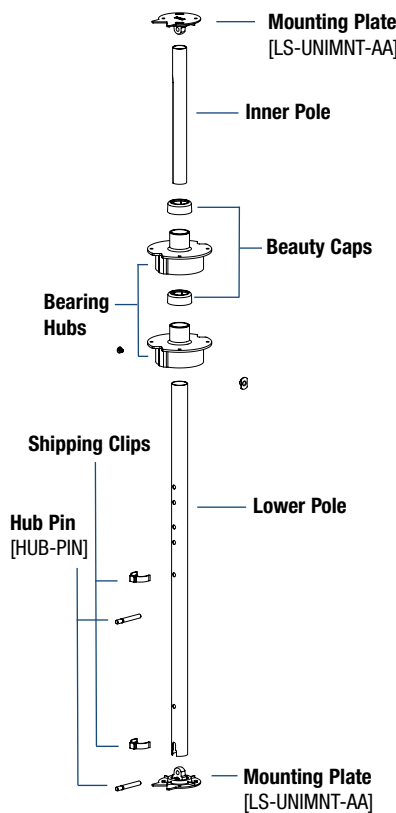
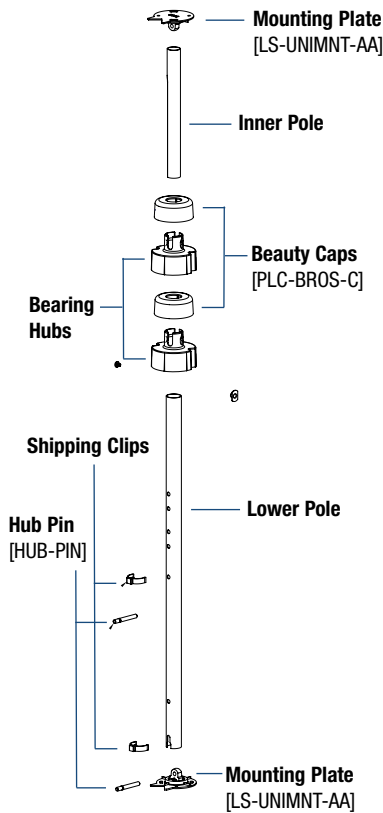

NOTE: Items with part numbers may be ordered individually, see page 27.

LAZY SUSAN POST HARDWARE PACKS											
STANDARD PACK #	Pkd.	BULK PACK #	Pkd.	For Shelf Type(s)	Bearing Hubs	Beauty/Post Caps	Mounting Plates	Post Height Range	STD. PK. Carton Wt.	BULK PK. Carton Wt.	
FULL-ROUND											
2	HWR-WFS-1-PC	1	–	–	Wood	Platinum	Chrome	Metal Unimount	25-1/2" – 31-1/2" [635 mm - 787 mm]	2.8 lbs. [1.3 kg.]	–
1	HN-F-TEL-PT	1	–	–	Polymer	White	–	Metal Unimount	25-1/2" – 31-1/2" [635 mm - 787 mm]	4.8 lbs. [2.2 kg.]	24 lbs. [10.9 kg.]
KIDNEY-SHAPED											
2	HWR-WKS-1-PC	1	–	–	Wood	Platinum	Chrome	Metal Unimount	25-1/2" – 31-1/2" [635 mm - 787 mm]	2.8 lbs. [1.3 kg.]	–
2	–	1	HWR-WS-BLK-10	10	Wood	White	White	White Plastic Unimount	25-1/2" – 31-1/2" [635 mm - 787 mm]	–	20 lbs. [9.1 kg.]
2	HWR-WS-1-DWL	1	–	–	Wood	White	White	Doweled White Plastic Unimount	25-1/2" – 31-1/2" [635 mm - 787 mm]	2.6 lbs. [1.2 kg.]	21.4 lbs. [9.7 kg.]
1	HN-K-TEL-PT	1	–	–	Polymer	White	Chrome	Metal Unimount	25-1/2" – 31-1/2" [635 mm - 787 mm]	1.9 lbs. [0.9 kg.]	9.5 lbs. [4.3 kg.]

All hardware packs include hub pins [HUB-PIN], shipping clips, installation hardware and instruction sheets.